

TremLock® Metal Roofing and Wall Solutions



TREMCO
ROOFING & BUILDING MAINTENANCE



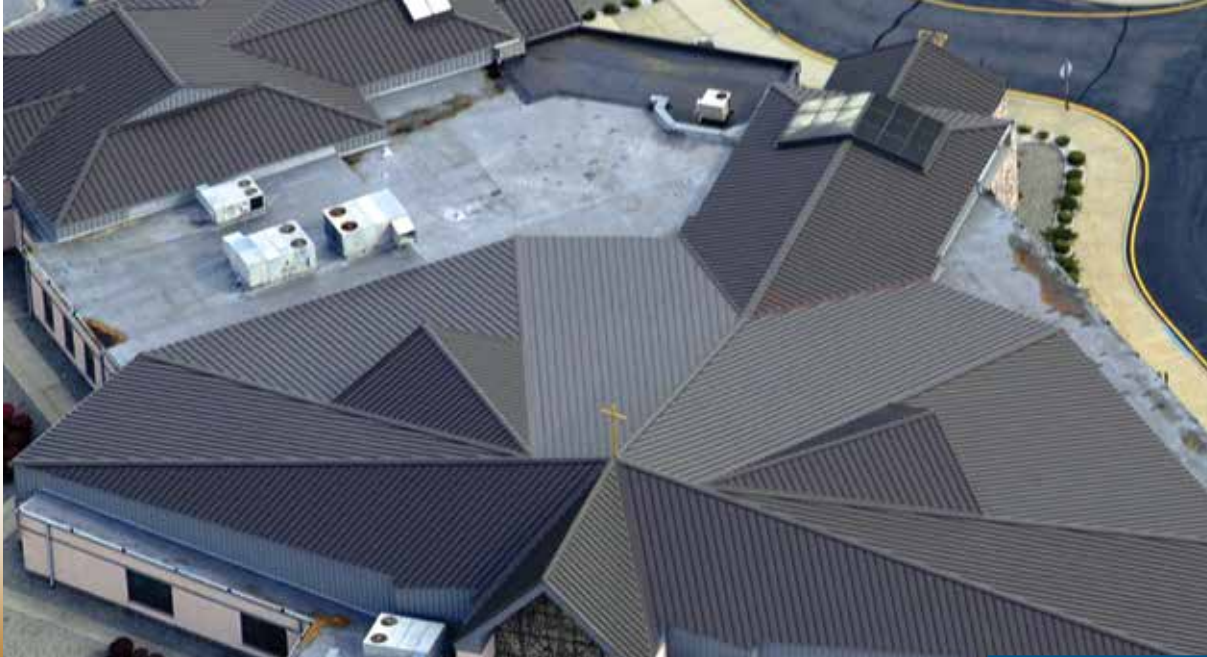

TABLE OF CONTENTS

PRODUCT

APPLICATION

SYSTEMS OVERVIEW

TremLock Roofing and Wall Solutions.....	4-5
--	-----

STANDING SEAM

TremLock T-138	Roof, Mansard	6
TremLock T-238	Roof, Mansard	7
TremLock VP	Roof, Mansard	8-9
TremLock SL	Roof, Fascia, Mansard	10
TremLock Narrow Batten	Roof, Fascia, Mansard	11
TremLock LSP	Roof.....	12

NON-EXPOSED FASTENER PANEL

TremLock Flexx Panel	Wall	13
TremLock Flush Panel	Soffit, Fascia, Wall	14
TremLock Soffit Panel	Soffit	14

EXPOSED FASTENER PANEL

TremLock 7.2 Panel	Roof, Wall	15
TremLock Ultra-Rib	Wall	16
TremLock "R" Plus	Roof, Wall	16
TremLock Shadow-Rib	Wall	16
TremLock Invisi-Lap	Wall	17
TremLock Mini-Rib	Wall, Fascia	17
TremLock "R" Panel	Roof, Wall	17
TremLock "M" & "S" Panel	Roof, Wall	18
TremLock "U" Panel	Roof, Wall	18

SLOPED FRAMING SYSTEM	19
-----------------------------	----

SUBSTRUCTURAL COMPONENTS	19
--------------------------------	----

COLOR SOLUTIONS	20-21
-----------------------	-------

TREMCO ROOFING INFORMATION & RESOURCES	22
--	----

TremLock® Metal Roofing and Wall Solutions



When you need a metal roof or metal walls that provide exceptional long term weatherproofing, are easy to maintain and look great, Tremco Roofing's TremLock series is the answer. With their flexible design and vibrant colors, TremLock metal roof and walls systems offer high performance for decades with minimal maintenance while enhancing the image and curb appeal of new or existing buildings. Our systems are also FM Global approved, ensuring better insurance rates for FM Global-insured businesses.

Long-Term Performance, Aesthetically Pleasing

While it's true that metal roofs and walls add color and dimension unlike other systems, their first role is to be watertight. TremLock metal roofs and walls are **pre-engineered** to provide the perfect fit for leak-free protection and long-term performance, eliminating water infiltration and ensuring a leak-free, watertight system.

Our metal roofing systems include:

TremLock T-138

An excellent option for new construction, remove and replace or in a direct application over shingles.

The TremLock T-138 versatile standing seam design and aesthetically pleasing appearance make it suitable for almost any roof configuration and complex geometrics. The most measurable benefits of the TremLock T-138 design include the ability to install directly over existing shingles without tearoff or underlayment and reduced utility expense by adding Above Sheathing Ventilation (ASV), 3/4" air space.

TremLock T-238

An excellent option for re-roofing, retrofitting and new construction.

With a minimum slope requirement of 1/2:12, this panel is ideal for almost any design. The most measurable benefit of the TremLock T-238 panel design is the ability to repair or replace individual panels. In addition to its superior performance benefits, the TremLock T-238 provides for a clean and simple installation. Since the clip is not seamed (only the "T" cap), there is no time spent on pre-tonging clips. With the panel's symmetrical shape, clips can be pre-installed to reduce labor time. This results in a lower total cost and insures a longer lasting roof.

TremLock VP

Standard design panel for new and retrofitted roof systems

The versatile, structural standing seam design and good looks make this system suitable for almost any roof configuration and complex geometric design. Excellent for architectural applications on roof slopes of 1/2:12 and greater, TremLock VP is capable of spanning secondary structural members spaced up to five feet apart and can be applied to light gauge steel framing, plywood and metal decks.

TremLock LSP

Strong construction for low-slope industrial roofs

Designed for low slopes (1/4:12 slope), this metal roof system is perfect for new construction over an open span or for retrofit construction over structural framing on an existing BUR or metal roof.

TremLock SL

Add the element of design to your steep-sloped new or retrofitted roof system

This system is used for roof slopes 3:12 and greater, fascias, mansards or equipment screens, and adds beauty to any roof or building. The TremLock SL panels quickly snap together for an easy installation and superior water-shedding capabilities.

Our 12 metal wall systems (technically, exposed fastener panels) for parapet walls and facades provide optimal strength, superior weatherproofing and excellent visual appeal for use in commercial, industrial and agricultural applications, as well as with pre-engineered metal buildings.

To complete your metal roof or wall system, Tremco Roofing and Building Maintenance also offers flush panels, soffit panels and a variety of sloped framing systems and substructural components. No matter what your metal roof or wall requirements are, you can solve them all with us.

STANDING SEAM



TremLock T-138 Roof Panel | STANDING SEAM SYSTEM

The TremLock T-138 is a symmetrical, two piece, mechanically seamed standing seam roof panel with a 1 3/8" seam height consisting of a metal panel and seam cap. The system is ideal for new construction, remove and replace or in direct application over shingles using our patent pending shingle recover clips with slopes down to 1:12. The seam is in the form of a "T" with two beads of continuous factory applied sealant located on the seam cap. Once installed, this two piece design provides a continuous, uninterrupted seal at the top of the seam.



TremLock T-138

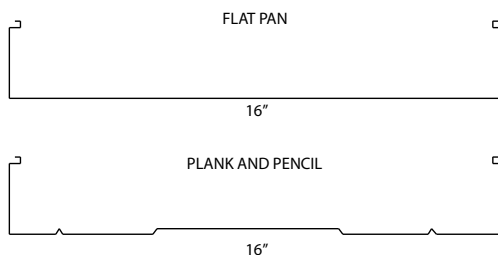

* All testing conducted with galvalume substrate.

* Oil canning (pan wave) is a natural occurrence in metal panels and is not cause for panel rejection.

Details

- › T-138 is a symmetrical panel system used on slopes down to 1:12
- › T-138 is a continuous length up to 200' curving available down to a radius of 6'
- › T-138 requires a solid substrate
- › Coating: Kynar 500

Testing Data (Galvalume Only) *

- › Uplift: UL 580, UL 1897, ASTM E1592
(Tested in accordance with ASTM and UL procedures)
- › Static Water: FM 4471 Appendix G, ASTM E2140
- › Air & Water Infiltration: ASTM E1680, ASTM E1646
- › Fire Rating: UL Class A

Panel Options

- › T-138 Panel Height & Width: 13 7/8" x 16"
- › Panel Configuration T-138 Flat, Plank and Pencil Rib
- › Gauge 24 with optional 22 Gauge Steel, .040 Aluminum, 20 Gauge Copper and Copper Plus
- › T-138 Manufacturing: Factory, job site roll-forming, curved, tapered on-site



STANDING SEAM

7

TremLock T-238 Roof Panel | STANDING SEAM SYSTEM

The TremLock T-238 is a symmetrical, two piece, mechanically seamed standing seam roof panel with a $2\frac{3}{8}$ " seam height consisting of a metal panel and seam cap. The system is ideal for retrofit or new construction on a broad range of substrate applications including open-framing, with slopes as low as $\frac{1}{4}$:12. The seam is in a form of a "T" with two beads of continuous factory-applied sealant located on the seam cap. Once installed, this two piece design provides a continuous, uninterrupted seal at the top of the seam.

Details

- › T-238 is a symmetrical roof/wall panel system used on slopes down to $\frac{1}{4}$:12
- › T-238 is a continuous length up to 300 ft. Tapered panels and convex curving available
- › Can be installed over open-framing, plywood or metal deck/rigid insulation
- › Coating: Kynar 500

Testing Data *

- › Class A - Fire Rating only
- › T-238 FM4471, UL580, UL1897, ASTM E - 1592 Uplift Test
- › ASTM E - 2140 - Water head
- › ASTM E - 1680 - Air Infiltration
- › ASTM E - 1646 - Water Infiltration
- › T-238 UL Class 4, FM Class 1 - SH - Impact Resistance

Panel Options

- › T-238 Panel Height & Width: $2\frac{3}{8}$ " x 12", 16", 18" or 24"
- › Panel Configuration T-238 Flat, Plank, Striations, Stiffener Ribs
- › Substrate: T-238 Alum-Zinc, Aluminum, Copper (Aluminum Available by Request)
- › Gauge 24 with optional 22 Gauge Steel and .040 Aluminum, .20 oz Copper and Copper Plus
- › T-238 Manufacturing: Factory, Job site roll-forming, curved onsite



TremLock T-238

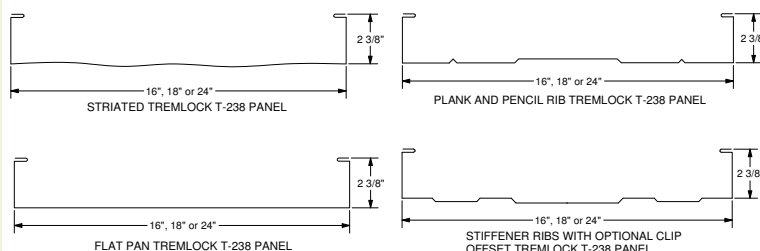

* All testing conducted with galvalume substrate.

* Oil canning (pan wave) is a natural occurrence in metal panels and is not cause for panel rejection.

STANDING SEAM

TremLock VP | STANDING SEAM SYSTEM

Offering strength, durability and aesthetics, vertical leg standing seam systems are the industry's preferred roofing panel. To meet the varying needs of specifiers and contractors, Tremco Roofing's TremLock VP line represents the industry's broadest selection of vertical leg systems.



Striated Panel Configuration Shown

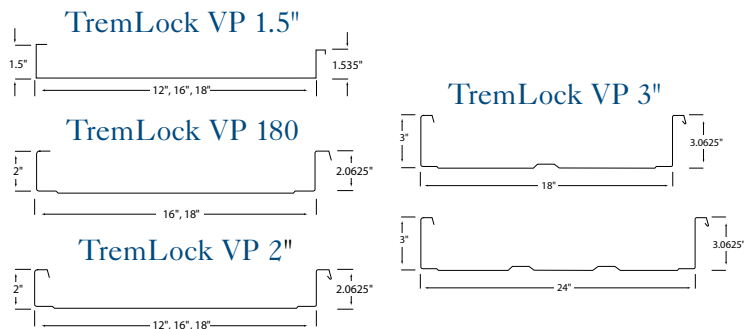

Factory Notching

For enhanced aesthetics and improved installation efficiency, TremLock VP panels are available with factory-fabricated eave and lap notching.

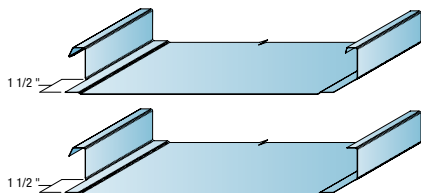

Details

- › Mechanically seamed profile
- › Factory applied sealant (on non-curved panels only)
- › Coating: Kynar 500®
- › 1:12 minimum slope for 1 1/2"
- › 1/2:12 minimum slope for 2"
- › 1/4:12 minimum slope for 3"
- › Can be installed over solid substrate or open framing
- › 1 1/2" and 2" also available

Testing Data (Galvalume Only) *

- › Class A - Fire Rating
- › UL580 Class 90 - Uplift Test
- › FM 4471 (1-90 Rated) - Uplift Test (2" only)
- › ASTM E1592 - Uplift Test (1 1/2, 2" & 3")
- › ASTM E1680 - Air Infiltration (2" & 3")
- › ASTM E1646 - Water Infiltration (2" & 3")
- › ASTM E - 2140 - Still water head
- › UL 2218 - Class 4 Impact Resistance
- › UL 263 Fire Resistance (2" & 3")

Panel Options

- › Panel Height & Width
1 1/2" x 12", 1 1/2" x 16", 1 1/2" x 18",
2" x 12", 2" x 16", 2" x 18",
3" x 18", 3" x 24"
- › Panel Configurations: Striated, Ribbed or Flat Pan
(1 1/2" & 2" seam only)
Minor Ribbed (3" Seam Only)
- › Substrate: Galvalume & Aluminum
- › Gauge: 22 and 24 Gauge Steel; .032 & .040 Aluminum
- › Factory formed eave or lap notch upon request



STANDING SEAM

9

2" TremLock VP and TremLock VP 1.5 panels are curved on the job site and feature a vertical leg that is mechanically seamed on the roof. These panels can also be installed flat (without a radius). Specifiers should use these systems if a 180° seam is desired.

Details

- › Panel width: 12", 16" or 18"
- › Panel Seam: 180 degree seam only for curved panels
Contact Technical Services for 1.5"
- › Minimum radius: 25' for 2" 180°, 12' for 1.5"
- › Coating: Kynar 500®
- › Substrates: 22, 24 gauge Galvalume, .032 Aluminum
- › Sealant to be field applied on curved applications
- › Also available - job site formed for long lengths

Testing Data (2" only) *

- › Class A - Fire Rating
- › ASTM E1592
- › UL 580 Class 90-Uplift Test
- › ASTM E1680-Air Infiltration
- › ASTM E1643-Water Infiltration
- › UL 2218 Class 4 Impact Resistance
- › UL 263 Fire Resistance

* All testing conducted with galvalume substrate.

* Oil canning (pan wave) is a natural occurrence in metal panels and is not cause for panel rejection.



Flat Panel Configuration Shown

STANDING SEAM SYSTEM

Use this chart to determine the best TremLock VP system for any project.

	1.5" seam height	2" seam height	3" seam height	90 degree seam	180 degree seam	curved	width
TremLock VP		☆			☆		12,16,18
TremLock VP				☆	☆		18,24
TremLock VP 2" 180			☆			☆	16,18
TremLock VP 2" 180C			☆			☆	16,18
TremLock VP 1.5 - 180	☆					☆	12,16,18
TremLock VP 1.5 - 180C	☆					☆	12,16,18

STANDING SEAM



TremLock SL | STANDING SEAM SYSTEM

A snap-together standing seam system that features a 1 3/4" seam, and can be installed over solid decking.



Pencil Rib Configuration Shown

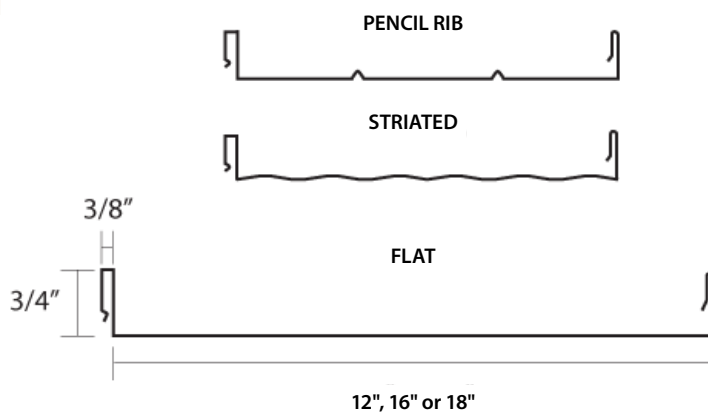

Details

- › Factory applied sealant placed in seams
- › Coating: Kynar 500®
- › 3:12 Minimum Slope
- › Factory panels available

Testing Data (Galvalume Only) *

- › Class A - Fire Rating
- › UL580 Class 90 - Uplift Test
- › ASTM E1592 - Uplift Test
- › ASTM E1680 - Air Infiltration
- › ASTM E1646 - Water Infiltration
- › UL 2218 - Class 4 Impact Resistance
- › UL 263 Fire Resistance

Panel Options

- › Panel Width: 12", 16" & 18"
- › Panel Configurations: Striated, Ribbed or Flat Pan
- › Substrate: Galvalume & Aluminum
- › Gauge: 22 and 24 Gauge Steel
- › Factory formed eave notch upon request

* All testing conducted with galvalume substrate.

* Oil canning (pan wave) is a natural occurrence in metal panels and is not cause for panel rejection.

STANDING SEAM

TremLock Narrow Batten | STANDING SEAM SYSTEM

TremLock Narrow Batten is an architectural standing seam system featuring a narrow batten cap applied over roofing panels with concealed clips. TremLock Narrow Batten is installed over solid decking only, and can also be curved to meet radius panel specifications.

Details

- › Must be installed over solid decking
- › Coating: Kynar 500®
- › 3:12 Minimum Slope

Testing Data *

- › Class A - Fire Rating
- › UL580 Class 90 - Uplift Test
- › ASTM E1680 - Air Infiltration
- › ASTM E1646 - Water Infiltration
- › UL 2218 - Class 4 Impact Resistance
- › UL 263 Fire Resistance
- › ASTM E1592

Panel Options

- › Panel Width: 12", 16" & 18"
- › Panel Configurations: Striated, Ribbed or Flat Pan
- › Substrate: Galvalume & Aluminum
- › Gauge: 24 Gauge Steel

Radius Details

- › Panel Width: 12", 16" & 18"
- › Minimum Radius: 30" for Steel
- › Panel Configurations: Ribbed or Flat Pan
- › Substrate: 24 Gauge Steel
- › Radius formed on site by contractor with leased Tremco Roofing equipment

* All testing conducted with galvalume substrate.

* Oil canning (pan wave) is a natural occurrence in metal panels and is not cause for panel rejection.



Flat Panel Configuration Shown

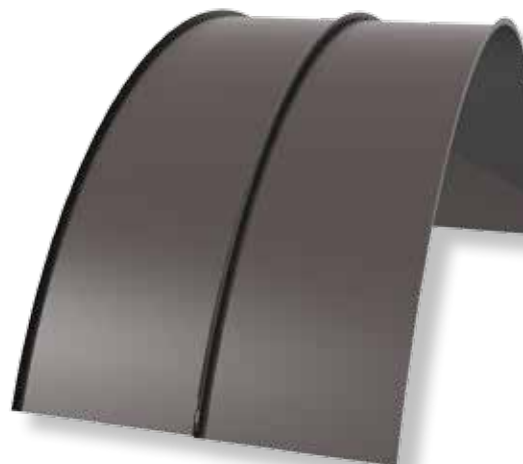
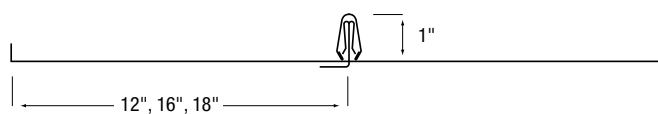

Flat Panel Configuration Shown

STANDING SEAM



TremLock LSP | STANDING SEAM SYSTEM

The TremLock LSP trapezoidal standing seam system is designed for projects with slopes as low as 1/4:12. These systems are best suited for simple sloped roofs without dormers, hips, valleys or other special conditions and can be installed over solid decking or substructural members. TremLock LSP is a field-seamed panel.

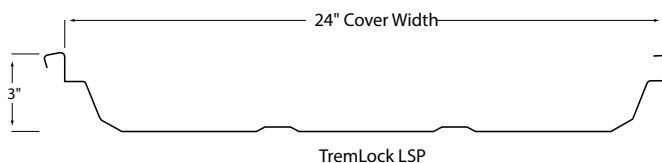

Details

- › Factory applied sealant in seam to improve weather-tightness
- › Can be installed over solid decking or open framing
- › Minimum Slope: 1/4:12
- › Coating: Kynar 500®

Testing Data *

- › Class A - Fire Rating
- › UL580 Class 90 - Uplift Test
- › UL 2218 - Class 4 Impact Resistance
- › ASTM E1680 - Air Infiltration
- › ASTM E1646 - Water Infiltration
- › ASTM E1592- Uplift Test
- › FM Class 1 - 90

Panel Options

- › Panel Width: 24"
- › Substrate: Galvalume
- › Gauge: 22 & 24 Gauge Steel

* All testing conducted with galvalume substrate.

* Oil canning (pan wave) is a natural occurrence in metal panels and is not cause for panel rejection.



NON-EXPOSED FASTENER PANEL

13

TremLock Flexx Wall Panel | NON-EXPOSED FASTENER PANEL

The TremLock Flexx Panel can only be installed horizontally. The TremLock Flexx Panel is designed for a solid substrate application to provide clean lines on new construction or retrofit. If you are looking for clean, textured appearance without visible fasteners, the Flexx wall panel is an excellent selection.

Details

- › A concealed fastener "hook & cleat" interlocking panel
- › Asymmetrical horizontal ribs used on wall applications
- › Coating: Kynar 500

Testing Data *

- › ASTM E -1592 Uplift Test

Panel Options

- › Panel Height & Width 3/4" x 16"
- › Substrates: Plywood, Nailers, Hat Channels, Purlins, Subgirts
- › Standard Materials: Alum-Zinc coated steel
- › Gauge 24 with optional 22 Gauge Steel

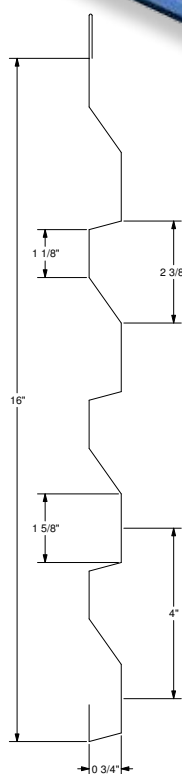
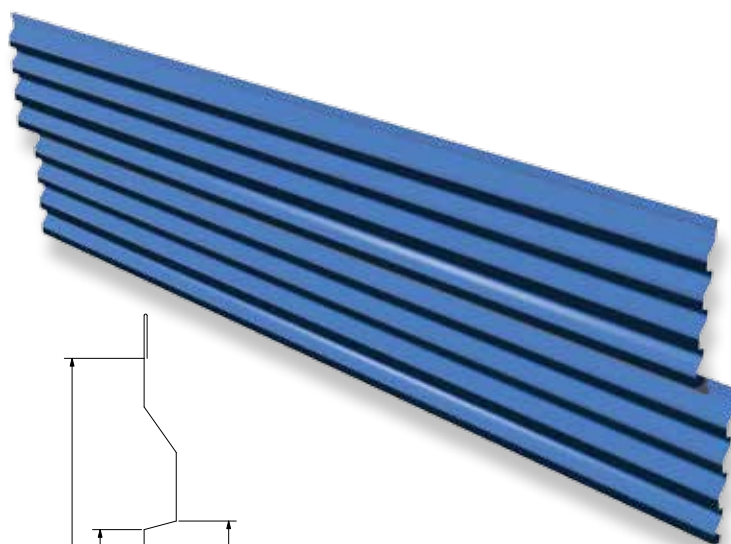

TremLock Flexx Panel

- * All testing conducted with galvalume substrate.
- * Oil canning (pan wave) is a natural occurrence in metal panels and is not cause for panel rejection.

NON-EXPOSED FASTENER PANEL

Flush Panel | SOFFIT, FASCIA & WALL PANEL

Flush Panel is a soffit, fascia and wall panel that is coated in colors matching Tremco Roofing's standing seam systems. The end result is assurance of exact color match between roof system, soffit, fascia and wall panels.



Solid or vented

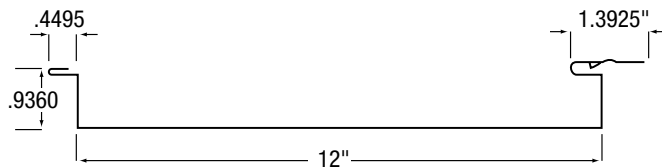

Details

- › Coating: Kynar 500°
- › Panel Width: 12"
- › 8% net free area with vented surface.

Testing Data *

- › ASTM E1592 - Uplift test

Panel Options

- › Panel Configurations: Flat Pan, Vented or Pencil Ribs
- › Substrate: Galvalume & Aluminum
- › Gauge: 22, 24 Gauge Steel (minimum quantities required)

Soffit Panel | SOFFIT PANEL

Soffit Panel systems will add an elegant touch to any commercial or residential project. Our Soffit Panel is available in a wide variety of gauges and Kynar 500° colors.



Solid or vented

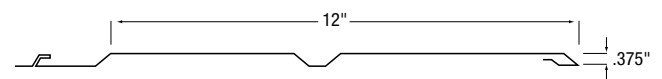

Details

- › Panel width: 12"
- › Panel Height: 0.375"
- › Maximum Length 20'
- › Major Rib Spacing: 6" oc.
- › Coating: Kynar 500°
- › 10% net free area with vented surface

Testing Data *

- › ASTM E1592 - Uplift test

Panel Options

- › Surface Configurations: Flat Pan or Vented
- › Substrate: Galvalume
- › Gauge: 24, 29 Gauge Steel

TremLock 7.2 | EXPOSED FASTENER PANELS

Our exposed fastener panels work exceptionally well on both parapet walls and facades. TremLock 7.2 is a panel with 7.2" rib spacing that provides optimum strength and spanning capabilities. TremLock 7.2 is equally well suited for industrial and commercial applications.

Details

- › 7.2" Rib Spacing
- › Coating: Kynar 500*

Testing Data

- › UL580 Class 90 - Uplift Test
- › ICCES Evaluation on 24 Gauge
- › UL263 Fire Resistance
- › Class A Fire Rating
- › ASTM E1680 - Air Infiltration
- › ASTM E1646 - Water Infiltration

Panel Options

- › 20 and 24 Gauge Standard
22 and 26 Gauge also available
- › TremLock 7.2 is also available with a 28 3/4" coverage, which is standard for 26 gauge panels. Please specify if 36" coverage is required.



TremLock 7.2 Panel

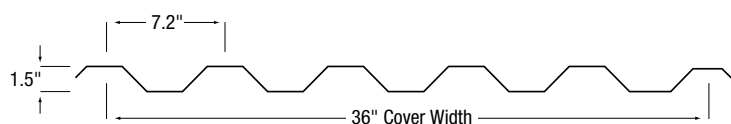

* All testing conducted with galvalume substrate.

* Oil canning (pan wave) is a natural occurrence in metal panels and is not cause for panel rejection.

EXPOSED FASTENER PANEL



Exposed Fastener Panels

TremLock Ultra-Rib

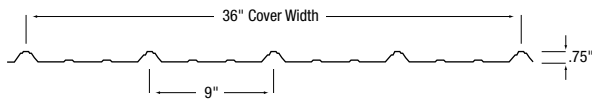

TremLock "R" Plus

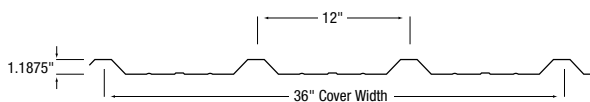

TremLock Shadow-Rib

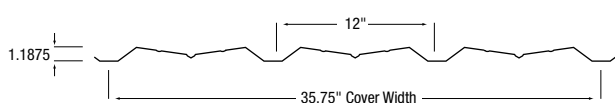

TremLock Ultra-Rib

TremLock Ultra-Rib is a low profile 3/4" panel that is well suited for commercial and agricultural applications.

Testing Data

- › UL580 Class 90 - Uplift Test
- › UL 2218 - Class 4 Impact Resistance
- › Class A - Fire Rating
- › UL263 - Fire Resistance

Panel Options

- › Gauge: 26, 24 Gauge Steel

TremLock "R" Plus

TremLock "R" Plus is a multi-use wall and roof panel used primarily in pre-engineered metal building applications.

Testing Data

- › UL580 Class 90 - Uplift Test
- › UL 2218 - Class 4 Impact Resistance
- › Florida State Approval: 1747.8, 1832.10
- › Class A - Fire Rating
- › UL263 - Fire Resistance

Panel Options

- › Gauge: 26, 24, 22 Gauge Steel

TremLock Shadow-Rib

TremLock Shadow-Rib is an exposed fastener wall panel that is designed so that fasteners are placed in the valleys, making them more difficult to see.

Panel Options

- › Gauge: 26, 24 Gauge Steel



EXPOSED FASTENER PANELS

17

Exposed Fastener Panels

TremLock Invisi-Lap

TremLock Invisi-Lap is a low profile 3/4" panel that is well suited for commercial and agricultural applications.

Panel Options

› Gauge: 26, 24 Gauge Steel

TremLock Mini-Rib

The symmetrical design of Tremco Roofing's Mini-Rib panel makes it an appealing profile for soffit, liner and fascia applications.

Panel Options

› Gauge: 26, 24 Gauge Steel

TremLock "R" Panel

TremLock R-Panel is a multi-use wall and roof panel used primarily in pre-engineered metal building applications.

Testing Data

- › UL580 Class 90 - Uplift Test
- › UL 2218 - Class 4 Impact Resistance
- › Florida State Approval: 1747.9, 1832.11
- › Class A - Fire Rating
- › UL263 - Fire Resistance
- › Miami Dade Approval (NOA# 08-1007.06)

Panel Options

› Gauge: 26, 24, 22 Gauge Steel

TremLock Invisi-Lap

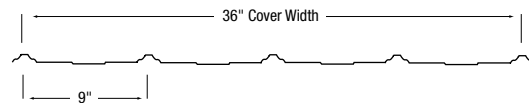

TremLock Mini-Rib

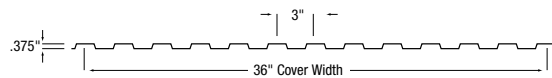

TremLock "R" Panel

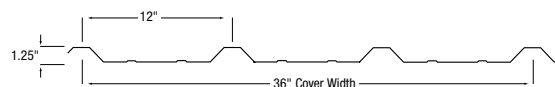

EXPOSED FASTENER PANELS



Exposed Fastener Panels

TremLock "M" Panel

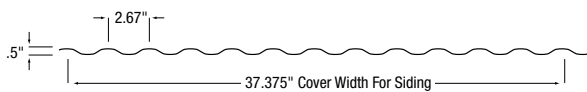

TremLock "S" Panel

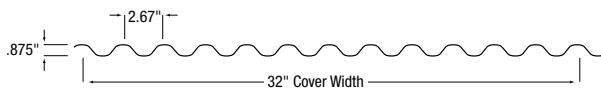

TremLock "U" Panel

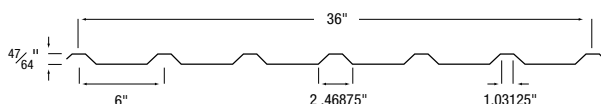

TremLock "M" & "S" Panel

Tremco Roofing's corrugated panels were designed and engineered with greater-than-normal spans and load-carrying characteristics in mind. They quickly communicate their high-strength performance capabilities and are equally well-suited for roof or wall applications. Our "M" & "S" are similar in design, with the "M" Panel offering a more subtle rib height and configuration.

Testing Data

- › UL 2218 - Class 4 Impact Resistance
- › Class A - Fire Rating
- › UL-580 Class 90 - Uplift Test

Panel Options

- › Gauge: 26, 24 Gauge Steel
- › 22 Gauge available with the "S" Panel Only

TremLock "U" Panel

TremLock U-Panel is an exposed fastener wall and roof panel that is also used extensively as a liner or partition panel.

Testing Data

- › UL580 Class 90 - Uplift Test
- › UL 2218 - Class 4 Impact Resistance
- › Class A - Fire Rating
- › UL263 - Fire Resistance

Panel Options

- › Gauge: 26, 24 Gauge Steel

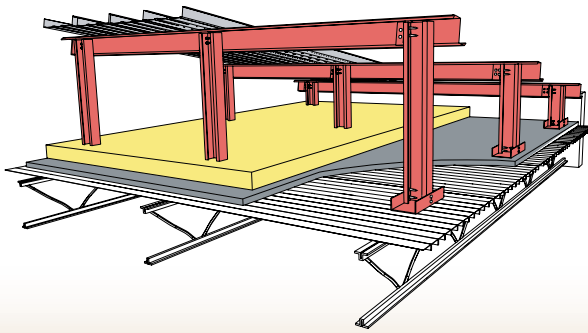

SECONDARY STEEL

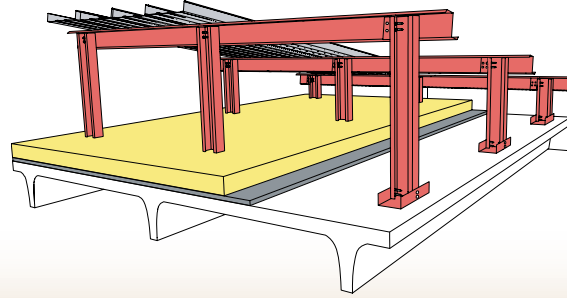

CONCRETE

SLOPED FRAMING SYSTEM

19

TremLock Sloped Framing Systems

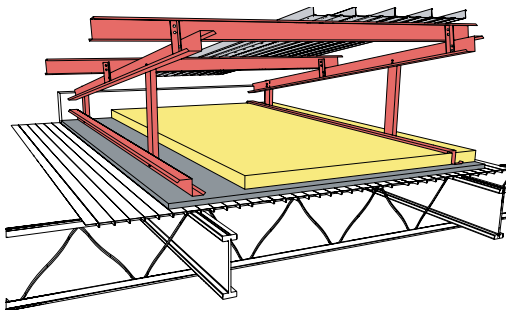

WIDE BAY STEEL

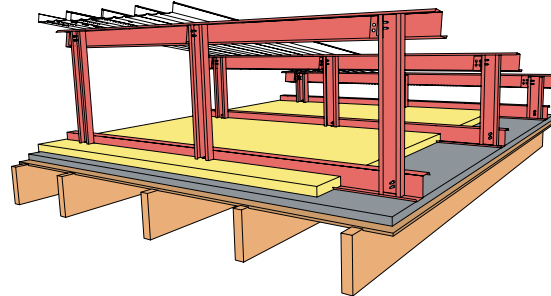

WOOD

Known for high-quality roofing products and exceptional services, Tremco Roofing and Building Maintenance is ready to be your source for retrofit metal roofing systems. Multiple framing methods are available to handle low and steep slope applications as well as a multitude of special conditions.

Substructural Components

Tremco Roofing's substructural components - Cees, Zees, Hats, Channels, Angles - represent the broadest selection of cold-formed substructural components in the industry. Our Cees and Zees are from Tremco Roofing and are manufactured in LGSI (Light Gauge Structural Institute) sections. LGSI sections have been found to have numerous advantages, including greater ease of installation.

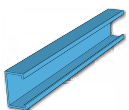

CEE

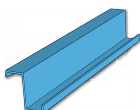

ZEE

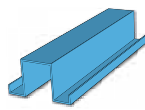

HAT

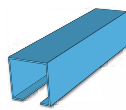

CHANNEL



MAC-GIRT

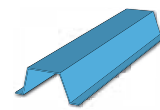

SUB-GIRT

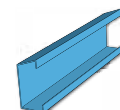

EAVE STRUT

Standard Colors

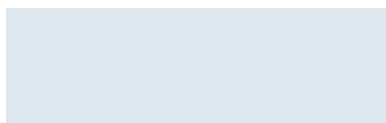

REGAL WHITE
R: 0.68 E: 0.86 SRI: 82

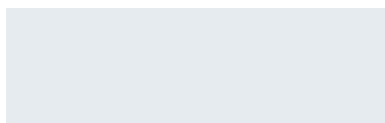

BONE WHITE
R: 0.71 E: 0.85 SRI: 86



SURREY BEIGE
R: 0.40 E: 0.86 SRI: 43



SANDSTONE
R: 0.54 E: 86 SRI: 63



ALMOND
R: 0.60 E: 84 SRI: 70



BUCKSKIN
R: 0.38 E: 86 SRI: 41



ASH GRAY
R: 0.39 E: 0.84 SRI: 41



SLATE GRAY
R: 0.43 E: 0.85 SRI: 47



CHARCOAL
R: 0.32 E: 0.85 SRI: 32



MATTE BLACK
R: 0.27 E: 0.86 SRI: 26



MEDIUM BRONZE
R: 0.30 E: 0.87 SRI: 31



DARK BRONZE
R: 0.26 E: 0.84 SRI: 24



PATINA GREEN
R: 0.46 E: 0.85 SRI: 51



EVERGREEN
R: 0.26 E: 0.84 SRI: 24



MANSARD BROWN
R: 0.30 E: 0.85 SRI: 30



COLONIAL RED
R: 0.33 E: 0.85 SRI: 34



ROMAN BLUE
R: 0.26 E: 0.85 SRI: 24



PATRICIAN BRONZE
R: 0.27 E: 0.86 SRI: 26



TERRA COTTA
R: 0.35 E: 0.85 SRI: 36

Tremco Roofing and Building Maintenance can help you create sustainable projects. All profiles are made from recycled steel and are offered in a full spectrum of energy saving Cool Colors. Contact your local Tremco Roofing sales representative for more information.

COLOR SOLUTIONS

21

Premium Colors ADDITIONAL COST WILL APPLY.



REGAL BLUE
R: 0.26 E: 0.85 SRI: 24



BRITE RED
R: 0.42 E: 0.84 SRI: 45



HARTFORD GREEN
R: 0.25 E: 0.85 SRI: 23



BRANDY WINE
R: 0.26 E: 0.85 SRI: 24

Colors are representative of colors offered and are not intended for matching purposes. Before placing an order, please request an actual color sample from Tremco Building & Roofing.

COLOR	*INVENTORY				
	Sunnyvale, Texas	Clinton, Illinois	Peachtree City, Georgia	Adelanto, California	Houston, Texas
Almond	✓	✓			
Ash Gray	✓	✓	✓	✓	✓
Bone White	✓	✓	✓	✓	✓
Brandywine	✓	✓	✓		✓
Brite Red	✓	✓	✓	✓	✓
Buckskin	✓	✓			✓
Champagne Metallic	✓				✓
Charcoal	✓	✓	✓	✓	✓
Colonial Red	✓	✓	✓	✓	✓
Copper Penny Metallic	✓	✓	✓	✓	✓
Dark Bronze	✓	✓	✓	✓	✓
Evergreen	✓	✓	✓	✓	✓
Hartford Green	✓	✓	✓	✓	✓
Leadcoat	✓				✓
Mansard Brown	✓	✓	✓	✓	✓
Matte Black	✓	✓	✓	✓	✓
Medium Bronze	✓	✓	✓	✓	✓
Patina Green	✓	✓	✓	✓	✓
Patrician Bronze	✓	✓	✓	✓	✓
Prewriteathered Galvalume	✓				✓
Regal Blue	✓	✓	✓	✓	✓
Regal White	✓	✓	✓	✓	✓
Roman Blue	✓	✓	✓	✓	✓
Sandstone	✓	✓	✓	✓	✓
Silver Metallic		✓	✓		
Slate Gray	✓	✓	✓	✓	✓
Surrey Beige		✓	✓	✓	✓
Terra Cotta	✓	✓			✓
Texas Silver Metallic	✓				✓

* ALL INVENTORY SHOWN IS 24 GAUGE GALVALUME MASTER COIL. OTHER GAUGES AND SUBSTRATES ARE AVAILABLE AND INVENTORY VARIES BY LOCATION. PLEASE INQUIRE FOR SPECIFIC INVENTORY AVAILABILITY AND FREIGHT RATES.

Metallic Colors

ADDITIONAL COST WILL APPLY.



PREWEATHERED GALVALUME
R: 0.30 E: 0.79 SRI: 27



LEADCOAT
R: 0.37 E: 0.82 SRI: 38



SILVER METALLIC
R: 0.57 E: 0.78 SRI: 64



COPPER PENNY METALLIC
R: 0.49 E: 0.85 SRI: 55



TEXAS SILVER METALLIC
R: 0.58 E: 0.78 SRI: 66



CHAMPAGNE METALLIC
R: 0.38 E: 0.80 SRI: 38



A COMMITMENT TO EXCELLENCE

In addition to our exceptional products, ongoing maintenance programs and relationships with quality contractors, Tremco Roofing and Building Maintenance offers a number of other advantages when you need a metal roofing or wall system, including:

- › Standard Kynar 500® coating that helps resist damage while remaining vibrant
- › Special color matching capabilities
- › Technical support
- › Meeting LEED criteria for recycled content and regionally manufactured materials (depending on the system selected and your location)

With sales representatives and facility service technicians across North America, Tremco Roofing and Building Maintenance helps manage building life cycles for customers in education, healthcare, government, manufacturing and many other industries. We are a division of Tremco Incorporated, which has been in business since 1928 and is itself part of the RPM Building Solutions Group, an international leader in the construction, maintenance and repair markets. Tremco Roofing works closely with Tremco Incorporated subsidiary WTI, which provides both general contracting and roofing services.



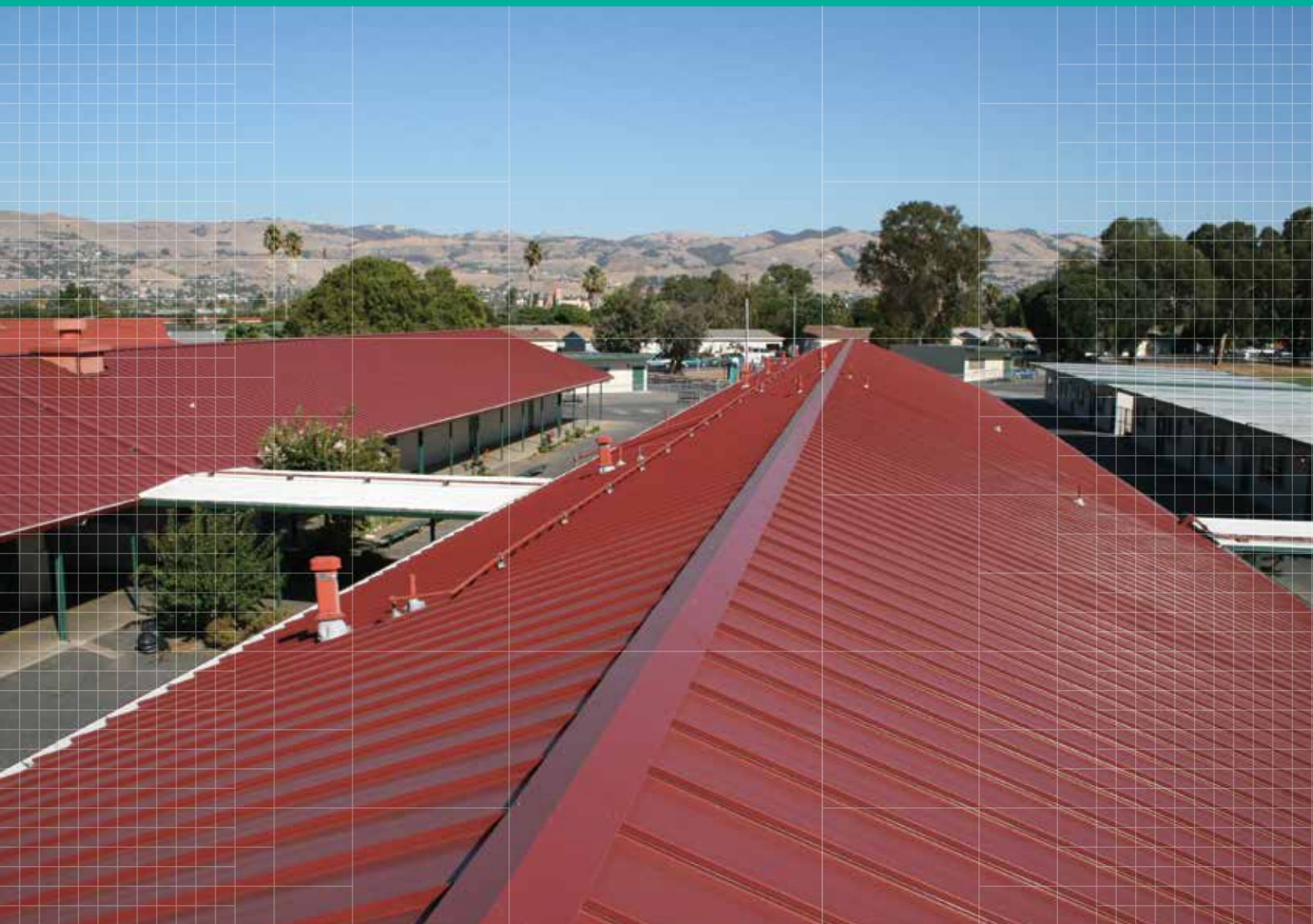

To learn more about how we can help you solve your metal roofing and wall challenges, or other facility issues you're facing, contact your local Tremco Roofing and Building Maintenance sales representative. You can also visit www.tremcoroofing.com or call us toll-free at 800.852.6013.

